

Technical Data Sheet

Astro Clad - AFFRCLAD6060 (VFB 60/60)

Revision 1 - 15th September 2022

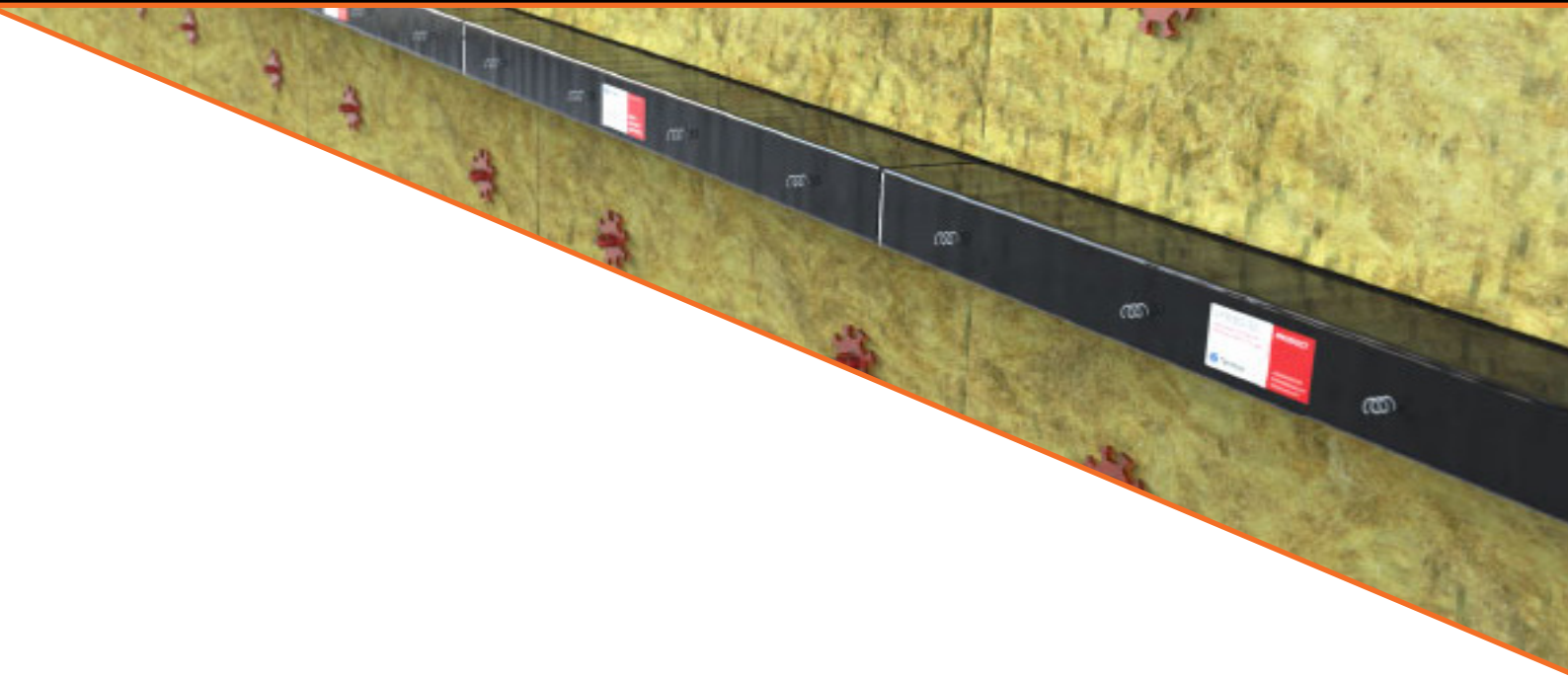



> Technical Data	General Product Description, Product Details & Sizes	> Page 1
> Technical Data	Fire Test Evidence	> Page 1
> Technical Data	Technical Information, General Design & Installation Considerations	> Page 2
> Technical Data	Fitting Instructions Astro Clad - AFFRCLAD6060 (VFB 60/60)	> Page 3-8

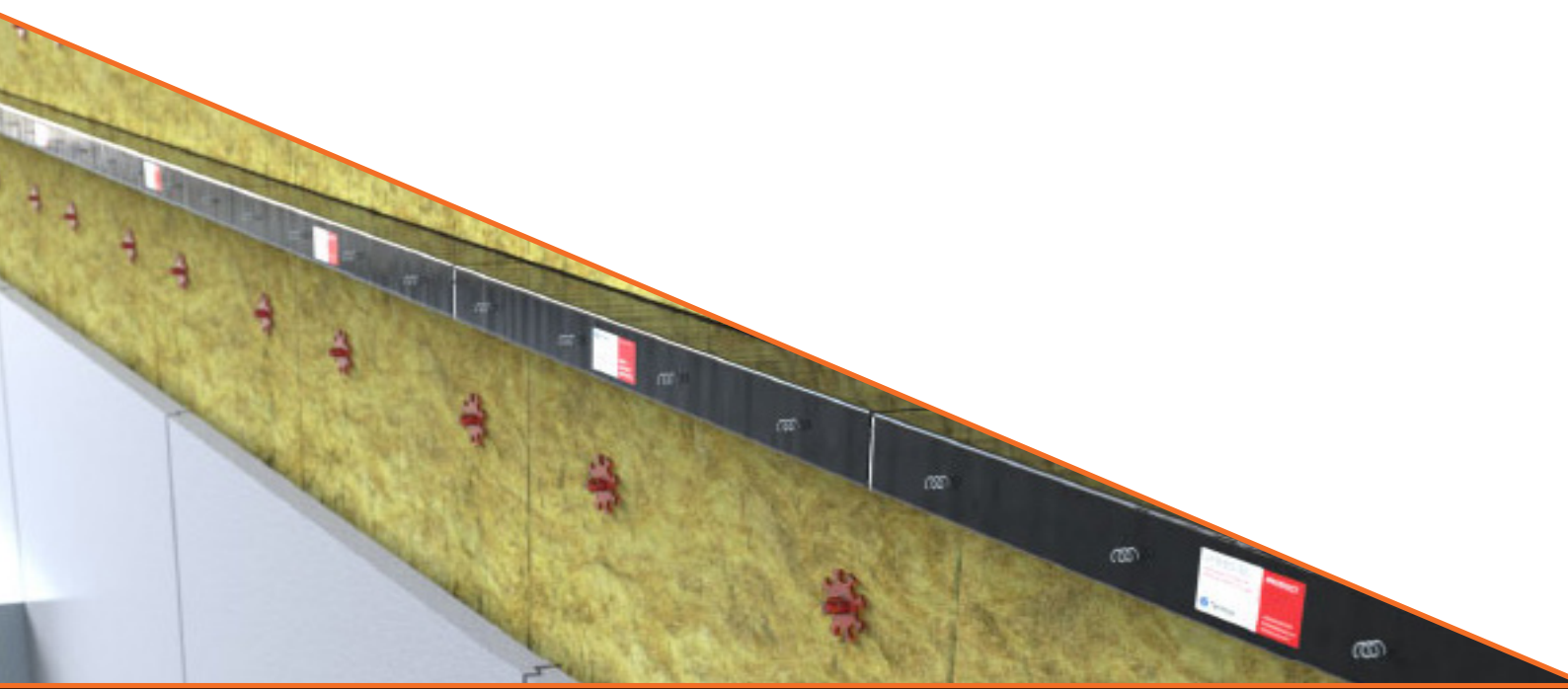

General Product Description

Astroflame’s Astro Clad - AFFRCLAD6060 (VFB 60/60) Ventilated Fire Barriers are ‘open state’ cavity fire barriers for ventilated cavities of up to 450mm. Each Astro Clad - AFFRCLAD6060 (VFB 60/60) consists of a specially formulated fire rated stone mineral wool section with an integral high expansion intumescent seal fixed to the leading edge.

The Astro Clad - AFFRCLAD6060 (VFB 60/60) then leaves a maximum 25mm air gap to allow for drainage and maintain ventilation in normal use. In a fire situation the intumescent seal rapidly expands to seal off the air gap and prevent vertical fire spread within the external wall.

The products have undergone extensive fire testing following the principles of BS EN1363-1 and in accordance with ASFP TGD19 (Fire Resistance Test for ‘Open-State’ Cavity Barriers).

The Astro Clad - AFFRCLAD6060 (VFB 60/60)s are mechanically fixed horizontally within ventilated cavities behind the external wall substrate following the fire compartment line. The Astro Clad - AFFRCLAD6060 (VFB 60/60)s are used horizontally and can be installed in conjunction with Astroflame’s Astro Clad - AFFRCLADNVFB (NVFB) Non-Ventilated Fire Barriers which provide vertical fire separation along fire compartment party wall lines.

Product Details

- 3rd party certification from IFC (Held by manufacturer).
- Typical Fire Ratings of minimum 60 Minutes Integrity and Insulation.
- Higher Fire Ratings available dependent on application.
- Maintains a 25mm air gap.
- Up to 450mm cavities tested.
- Standard thickness of 75mm.
- Durability and Age Tested.
- Fixing brackets included as standard.

Sizes

Thickness (Total Cavity less 25mm Air Gap) x 75mm x 1000mm

Fire Test Evidence

Fire Test performance to BS EN 1363-1 and to the principles of ASFP TGD19									
Inner Leaf Substrate Type (facing cavity) with Appropriate minutes (EI) Fire Rating	Outer leaf Substrate Type (facing cavity) With Appropriate Fire Resistance	Orientation	Insulation Type Within Cavity (interrupted)	Maximum Cavity Width (in mm)	Maximum Open State Air Gap (In mm)	Product Dimensions (thickness x height x length in mm)	Product Fire Resistance Rating		Fire Test Report Number
							Integrity	Insulation	
Autoclaved Aerated Concrete	Autoclaved Aerated Concrete	Horizontal	None	40	25	15 x 75 x 1,000	180	180	Warringtonfire WF433220
12.5mm Weather Defence Board on SFS	Autoclaved Aerated Concrete	Horizontal	25mm Phenolic	60	25	35 x 75 x 1,000	120	120	Warringtonfire WF436593
Autoclaved Aerated Concrete	100mm thick 100kg/m ³ stone wool (Rockwool)	Horizontal	100mm PIR	300	25	275 x 75 x 1,000	120	120	Warringtonfire WF436588A
Autoclaved Aerated Concrete	Autoclaved Aerated Concrete	Horizontal	100mm PIR	300	25	275 x 75 x 1,000	60	60	Warringtonfire WF394958
10mm Cement Particle Board	Autoclaved Aerated Concrete	Horizontal	100mm PIR	450	25	425 x 75 x 1000	60	60	Warringtonfire WF430196

Notes

The types of insulation tested do not infer generic approval for these insulation products and approval should be sought from the insulation manufacturers depending upon the particular type of construction being built.

Insulation is tested interrupted to prevent the possibility of fire bypassing behind the cavity barrier. Testing using a combustible substrate covers a limited combustible or non-combustible substrate.

The ASFP-TGD19 test standard allows for insulation to be replaced with insulation that is listed as better using the hierarchy as below and must be installed interrupted.

Notes on insulation from TGD19:2017-13.3 Insulation. For interrupted insulation the following hierarchy is used: Best- stone wool, glass wool, phenolic, PIR, PUR, EPS - Worst.

Technical Information

Colour	Black
Finish	Polythene Wrap
Cuttability	Can be cut to length
Storage	Dry, ambient
Transportation Storage Temperature	-20°C to +70°C
Durability	Type X intended for use in conditions exposed to weather (UV, rain, frost)
Fungal Resistance	Protected by polythene
Smoke/Halogen Content	Low Smoke / Zero Halogen
Minimum Total Working Life (Years)	Based on typical climatic conditions UK 60 years Australia 45 years France 60 years New Zealand 60 years Germany 60 years Hong Kong 40 years The Netherlands 60 years

Working life, durability, halogen content and smoke emission data refers to the active intumescent component.

General Design & Installation Considerations

Maximum free air gap for this cavity barrier is 25mm, the space in front of the intumescent strip on the face of the cavity barrier to the rear of the external wall surface.

Open state cavity barriers should be installed in a continuous run, (with the exception of abutting up to full fill vertical cavity barriers). Where this is not possible, details should be agreed with the projects principal designer and or fire engineer.

Horizontal cavity barriers should be installed adjacent and tightly abutted to any vertical cavity barriers, the vertical cavity barriers should be installed first.

Cavity barriers may be cut to length as required, adjacent lengths must be tightly abutted together. The intumescent face of the cavity barrier should be unrestricted and free to expand in a fire situation, fully filling the cavity.

An identification label is attached to the intumescent face of the cavity barrier, ensure this faces out into the open cavity. Also ensure the label is visible and legible and reads the right way up.

If the identification label is not legible please contact Astroflame, the label is important in terms of identifying the product in the future, for example during fire risk assessments or fire safety inspections.

Cavity barrier fixing brackets, both multi purpose, (MP bracket) or high performance (HP bracket) must not penetrate through the face of the cavity barrier. Screws for direct fixing and fixings to secure brackets are not supplied by Astroflame.

The brackets used to fix the horizontal cavity barrier must be installed with the spike inserted centrally (horizontally) to the rock mineral wool section of the cavity barrier with the bracket fixed above and not below the cavity barrier.

The use of tape is not required over the joints between the lengths of cavity barrier, and if used should not be applied over the face of intumescent material.

The cavity barrier must be installed following the installation methods described below. The cavity barrier must not be penetrated by any other mechanical or electrical services.

Fitting Instructions Astro Clad - AFFRCLAD6060 (VFB 60/60)

Fire Barrier Support Details								
Cavity Size (mm)	Product Width (mm)	Fitting Option Number	Barrier Support Type	No. of support (brackets) fixings per metre	Maximum (brackets) Centres (mm)	Front Face / Intumescent Fixing	No. of (Face) Fixings per metre	Front Face Fixing Centres (mm)
40-100	15-75	1	Screw	NA	NA	Screw	4	250
101-115	76-90	2	MP Bracket	2	500	Pigtail Screws	4	250
116-240	91-215	3	MP Bracket	2	500	Pigtail Screws	4	250
241-300	216-275	4	MP Bracket	3	350	Pigtail Screws	4	250
301-450	276-425	5	HP Bracket	2	500	Pigtail Screws	4	250

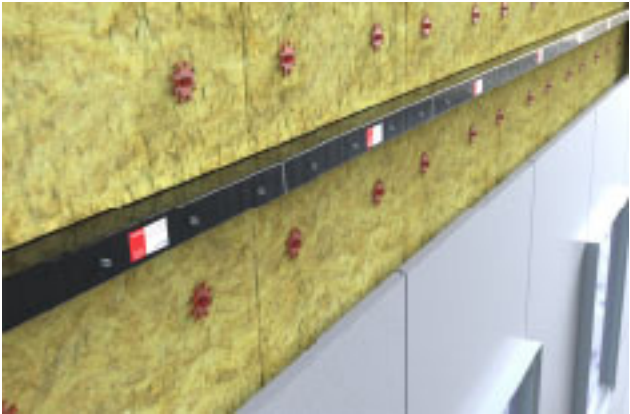

Option 1

Astro Clad - AFFRCLAD6060 (VFB 60/60) - Product width across cavity 16mm up to 75mm wide, directly faced fixed, no additional pigtails required.

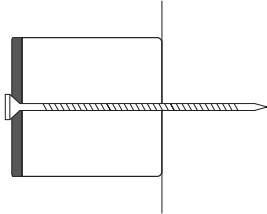

Use stainless steel countersunk head screws, with a maximum head diameter of 11.5mm and with a length suitable for the size of cavity barrier and sufficient fixing depth into the substrate.

Fixings must have an appropriate fixing depth for the substrate (with a minimum of 50mm for masonry fixings and minimum 25mm for timber unless otherwise specified by the fixing manufacturers guidance for their fixing type).

Ensure that the countersunk screw head does not fully penetrate the face of the cavity barrier, the screw head should sit flush or slightly proud.

Care should be taken not to over tighten as this may affect the performance of the intumescent seal.

Position the first screw fixing through the centre line of the face of the cavity barrier at a maximum 125mm from one end, continue to face fix through at maximum 250mm centres (4 screws per linear meter), ensuring that the final fixing is a maximum 125mm from the end of the cavity barrier. This will ensure that face fixings are positioned at 250mm centres across the continuous run of cavity barrier.

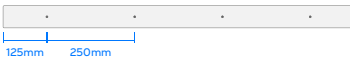

Where sections of cavity barrier are less than 1 linear meter in length, ensure that face fixings are positioned at a maximum 125mm from each end with additional fixing being positioned at maximum 250mm centres between the end fixings.

For cut sections of cavity barrier less than or equal to 250mm in length only one fixing is required.

Option 2

Astro Clad - AFFRCLAD6060 (VFB 60/60) - Product width across cavity from 76mm up to 90mm wide, fixed using 2 multi purpose (MP) 65mm brackets and 4 number pigtail screws (per linear meter).

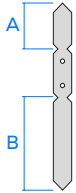

MP brackets are supplied with 2 fixing spikes, one spike is 65mm long (A), the other is 160mm long (B), with a central pre drilled section for securing the bracket to the substrate.

For cavity barriers 76mm-90mm wide (across cavity) use 2 MP brackets and the 65mm (A) long spike.

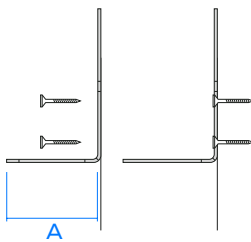

To secure the bracket use nom. 5mm Ø stainless steel screws/fixings, with a maximum head diameter of 13mm and with a length and type suitable for the substrate.

Ensure that the screw head sits as flush as possible with the substrate.

Fix through both of the fixing holes.

Fixings must have an appropriate fixing depth for the substrate (with a minimum of 50mm for masonry and minimum 25mm for timber unless otherwise specified by the fixing manufacturers guidance for their fixing type).

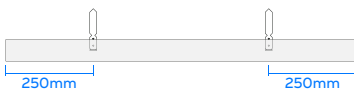

Fix 2 number MP brackets, per linear meter, to the substrate at maximum 250mm from the end of the cavity barrier, with a maximum spacing between brackets of 500mm.

Where sections of cavity barrier are less than 1 linear meter in length, ensure that MP brackets are positioned at a maximum 250mm from each end. For cut sections of cavity barrier less than or equal to 500mm in length only one MP bracket is required.

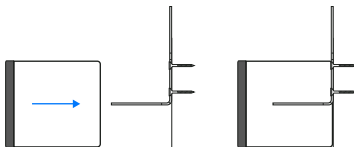

Push the cavity barrier onto the bracket spike, the brackets should impale the Astro Clad - AFFRCLAD6060 (VFB 60/60) to mid barrier depth and must not protrude through the intumescent element.

The cavity barrier should be pushed fully onto the bracket spike and sit flush with the substrate at the rear of the cavity barrier, ensuring that there are no gaps behind the cavity barrier.

Screw the pigtail screws through the face of the intumescent material on the face of the cavity barrier (the face with the label).

Position the first pigtail screw fixing through the face of the cavity barrier at a maximum 125mm from one end, continue to face fix through at maximum 250mm centres (4 pigtail screws per linear meter), ensuring that the final pigtail fixing is a maximum 125mm from the end of the cavity barrier.

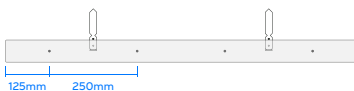

This will ensure that pigtail fixings are positioned at 250mm centres across the continuous run of cavity barrier.

The pigtails should be screwed in to the face of the cavity barrier to a depth which leaves 25mm of the pigtail proud of the intumescent face of the cavity barrier.

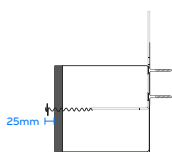

Where sections of cavity barrier are less than 1 linear meter in length, ensure that pigtails are positioned at a maximum 125mm from each end with additional fixing being positioned at maximum 250mm centres between the end pigtails.

Where the space between the end pigtails exceeds 250mm additional pigtails will be required.

Where the cavity barrier is less than 250mm in length only 1 pigtail will be required.

All sections of cavity barrier require pigtail screws unless directly faced fixed through the cavity barrier, as per option 1.

Option 3

Astro Clad - AFFRCLAD6060 (VFB 60/60) - Product width across cavity from 91mm up to 215mm wide, fixed using 2 multi purpose (MP) 160mm brackets and 4 number pigtail screws (per linear meter).

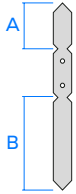

MP brackets are supplied with 2 fixing spikes, one spike is 65mm long (A), the other is 160mm long (B), with a central section for securing the bracket to the substrate.

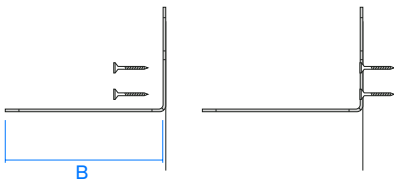

For cavity barriers 91mm-215mm wide (across cavity) use 2 MP brackets and the 160mm (B) long spike. To secure the bracket use nom. 5mm Ø stainless steel screws/fixings, with a maximum head diameter of 13mm and with a length and type suitable for the substrate. Ensure that the screw head sits as flush as possible with the substrate.

Fix through both of the fixing holes.

Fixings must have an appropriate fixing depth for the substrate (with a minimum of 50mm for masonry and minimum 25mm for timber unless otherwise specified by the fixing manufacturers guidance for their fixing type).



For cavity barriers 91mm-215mm wide (across cavity) use 2 MP brackets and the 160mm long spike. The 160mm spike will require cutting to size, if used in barriers less than 185mm wide, to ensure that the spike does not pierce through the face of the intumescent material, the bracket should be cut to provide a minimum projection through the barrier to 3/4 of the cavity barrier width and to a maximum of 25mm behind the face of the intumescent strip.

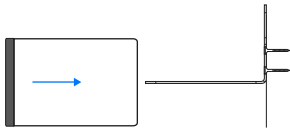

Fix 2 number MP brackets, per linear meter, to the substrate at maximum 250mm from the end of the cavity barrier, with a maximum spacing between brackets of 500mm. Where sections of cavity barrier are less than 1 linear meter in length, ensure that MP brackets are positioned at a maximum 250mm from each end. Where the cavity barrier is less than or equal to 500mm in length 1 MP bracket may be used.

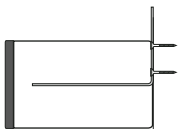

Push the cavity barrier onto the bracket spike, the brackets should impale the Astro Clad - AFFRCLAD6060 (VFB 60/60) to mid barrier depth and must not protrude through the intumescent element.

The cavity barrier should be pushed fully onto the bracket spike and sit flush with the substrate at the rear of the cavity barrier, ensuring that there are no gaps behind the cavity barrier.



Screw the pigtail screws through the face of the intumescent material on the face of the cavity barrier (the face with the labels).

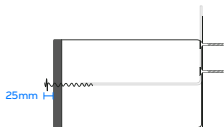

Position the first pigtail screw fixing through the face of the cavity barrier at a maximum 125mm from one end, continue to face fix through at maximum 250mm centres (4 pigtail screws per linear meter), ensuring that the final pigtail fixing is a maximum 125mm from the end of the cavity barrier.

This will ensure that pigtail fixings are positioned at 250mm centres across the continuous run of cavity barrier.

The pigtails should be screwed in to the face of the cavity barrier to a depth which leaves 25mm of the pigtail proud of the intumescent face of the cavity barrier.

Where sections of cavity barrier are less than 1 linear meter in length, ensure that pigtails are positioned at a maximum 125mm from each end with additional fixing being positioned at maximum 250mm centres between the end pigtails.

Where the space between the end pigtails exceeds 250mm additional pigtails will be required. Where the cavity barrier is less than 250mm in length only 1 pigtail will be required.

All sections of cavity barrier require pigtail screws unless directly faced fixed through the cavity barrier, as per option 1.

Option 4

Astro Clad - AFFRCLAD6060 (VFB 60/60) - Product width across cavity from 216mm up to 275mm wide, fixed using 3 multi purpose (MP) 160mm brackets and 4 number pigtail screws (per linear meter).

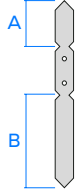

MP brackets are supplied with 2 fixing spikes, one spike is 65mm long, the other is 160mm long, with a central section for securing the bracket to the substrate.

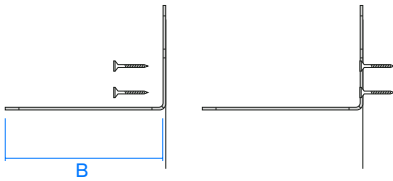

For cavity barriers 216mm-275mm wide (across cavity) use 3 MP brackets and the 160mm (B) long spike. To secure the bracket use nom. 5mm Ø stainless steel screws/fixings, with a maximum head diameter of 13mm and with a length and type suitable for the substrate.

Ensure that the screw head sits as flush as possible with the substrate.

Fix through both of the fixing holes.

Fixings must have an appropriate fixing depth for the substrate (with a minimum of 50mm for masonry and minimum 25mm for timber unless otherwise specified by the fixing manufacturers guidance for their fixing type).

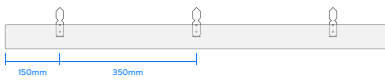

Fix 3 number MP brackets, per linear meter, to the substrate at maximum 150mm from the end of the cavity barrier, with a maximum spacing between brackets of 350mm.

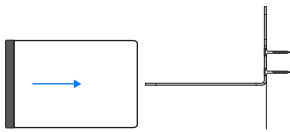

Where sections of cavity barrier are less than 1 linear meter in length, ensure that MP brackets are positioned at a maximum 150mm from each end.

Where the cavity barrier is less than or equal to 350mm in length 1 MP bracket may be used.

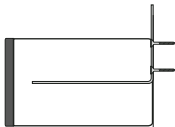

Push the cavity barrier onto the bracket spike, the brackets should impale the Astro Clad - AFFRCLAD6060 (VFB 60/60) to approximately mid barrier depth and must not protrude through the intumescent element.

The cavity barrier should be pushed fully onto the bracket spike and sit flush with the substrate, at the rear of the cavity barrier, ensuring that there are no gaps behind the cavity barrier.



Screw the pigtail screws through the face of the intumescent material on the face of the cavity barrier (the face with the labels).

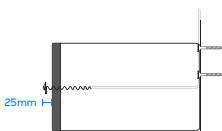

Position the first pigtail screw fixing through the face of the cavity barrier at a maximum 125mm from one end, continue to face fix through at maximum 250mm centres (4 pigtail screws per linear meter), ensuring that the final pigtail fixing is a maximum 125mm from the end of the cavity barrier.

This will ensure that pigtail fixings are positioned at 250mm centres across the continuous run of cavity barrier.

The pigtails should be screwed in to the face of the cavity barrier to a depth which leaves 25mm of the pigtail proud of the intumescent face of the cavity barrier.

Where sections of cavity barrier are less than 1 linear meter in length, ensure that pigtails are positioned at a maximum 125mm from each end with additional fixing being positioned at maximum 250mm centres between the end pigtails.

Where the space between the end pigtails exceeds 250mm additional pigtails will be required.

Where the cavity barrier is less than 250mm in length only 1 pigtail will be required.

All sections of cavity barrier require pigtail screws unless directly faced fixed through the cavity barrier, as per option 1.

Option 5

Astro Clad - AFFRCLAD6060 (VFB 60/60) - Product width across cavity from 276mm-425mm wide, fixed using 2 high performance (HP) 328mm brackets and 4 number pigtail screws (per linear meter).

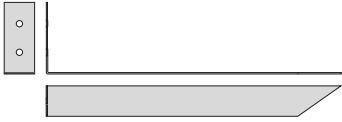

HP brackets are supplied with a single fixing spike, at 328mm long with two pre drilled fixing holes and a 90° return angle for securing the bracket to the substrate.

The 328mm spike will require cutting to size, if used in barriers less than 350mm wide, to ensure that the spike does not pierce through the face of the intumescent material.

The bracket should be cut to provide a minimum projection through the barrier to 3/4 of the cavity barrier width and to a maximum of 25mm behind the face of the intumescent strip.



To secure the bracket use nom. 5mm Ø stainless steel screws/fixings, with a maximum head diameter of 13mm and with a length and type suitable for the substrate.

Ensure that the screw head sits as flush as possible with the substrate.

Fix through both of the fixing holes.

Fixings must have an appropriate fixing depth for the substrate (with a minimum of 50mm for masonry and minimum 25mm for timber unless otherwise specified by the fixing manufacturers guidance for their fixing type).

Fix 2 number HP brackets, per linear meter, to the substrate at maximum 250mm from the end of the cavity barrier, with a maximum spacing between brackets of 500mm.



Where sections of cavity barrier are less than 1 linear meter in length, ensure that MP brackets are positioned at a maximum 250mm from each end. Where the cavity barrier is less than or equal to 500mm in length 1 HP bracket may be used.



Push the cavity barrier onto the bracket spike, the brackets should impale the Astro Clad - AFFRCLAD6060 (VFB 60/60) to approximately mid barrier depth and must not protrude through the intumescent element. The cavity barrier should be pushed fully onto the bracket spike and sit flush with the substrate, at the rear of the cavity barrier, ensuring that there are no gaps behind the cavity barrier.

Screw the pigtail screws through the face of the intumescent material on the face of the cavity barrier (the face with the labels).



Position the first pigtail screw fixing through the face of the cavity barrier at a maximum 125mm from one end, continue to face fix through at maximum 250mm centres (4 pigtail screws per linear meter), ensuring that the final pigtail fixing is a maximum 125mm from the end of the cavity barrier.



This will ensure that pigtail fixings are positioned at 250mm centres across the continuous run of cavity barrier.

The pigtails should be screwed in to the face of the cavity barrier to a depth which leaves 25mm of the pigtail proud of the intumescent face of the cavity barrier.

Where sections of cavity barrier are less than 1 linear meter in length, ensure that pigtails are positioned at a maximum 125mm from each end with additional fixing being positioned at maximum 250mm centres between the end pigtails.

Where the space between the end pigtails exceeds 250mm additional pigtails will be required.

Where the cavity barrier is less than 250mm in length only 1 pigtail will be required.

All sections of cavity barrier require pigtail screws unless directly faced fixed through the cavity barrier, as per option 1.

Installation

We have technical representatives who provide assistance in the selection and specification of the products on this site and should be consulted for exact installation and product suitability. Ensure an early engagement with ourselves, designers, main contractor and specialist installers before any installation. Other trades and/or manufacturers may need to be consulted. For in-depth information, specification and technical advice please call our Head Office on tel [01329 844 500](tel:01329844500) or email sales@astroflame.com

Maintenance

All interested parties, designer, specifier, main contractor and specialist installers should provide access to allow the fire stopping seals to be regularly inspected and maintained, as well as records kept of such maintenance at minimum periods of 12 months, as required by the Regulatory Reform Order, and repaired if necessary. Reference should be made to the relevant Code of Practice for the Installation and Inspection of Fire Stopping.

Competency

It is vital that those entrusted to design or install a fire stopping product have the necessary levels of competence to undertake the task professionally and thoroughly. The level of competency required will be commensurate with the expected complexity of the building. All designers must eliminate, reduce or control foreseeable risks that may arise during installation, construction or maintenance when preparing or modifying designs. Clients should ensure that the principal designer and principal contractor carry out their duties under CDM regulations. The ASFP foundation course in passive fire protection provides essential knowledge as part of demonstrating competency and understanding in this key fire protection specialism.

Additional Notes

This product can only be supplied once the cladding enquiry form has been completed and approved by the manufacturer: Click the following link to download the: [Cavity Barrier Form](#)

As part of our policy of ongoing improvements, we reserve the right to modify, alter or change product specifications without giving notice. Product illustrations are representations only. All information contained in this document is provided for guidance only, and as ASTROFLAME (FIRE SEALS) LTD has no control over the specific application or installation methods of the products, or of the prevailing site conditions, no warranties expressed or implied are intended to be given as to the actual performance of the products mentioned or referred to, and no liability whatsoever will be accepted for any loss, damage or injury arising from the use of the information given of products mentioned or referred to herein.

The above information to the best of our knowledge is true and accurate and based upon current test data and is supplied for your guidance only. Customers should satisfy themselves to the suitability of the product based on the products limitation of applications and that the product is fit for purpose for their intended use and no guarantee is given or implied since the conditions of actual use are beyond our control. ASTROFLAME (FIRE SEALS) LTD, disclaim any liability for loss, damage or other expense arising from the use of information, data or products mentioned or referred to and reserve the right to change any details or specifications without notice. If you are in any doubt as to the suitability of this product for your intended application please contact our technical team on 01329 844500 or email sales@astroflame.com and we will contact you.