

Product Data Sheet

Raven Products Door Bottom Smoke Seals

Revision 3 - 4th February 2019



Raven Products Smoke Seals

Door Bottom Smoke Seals

- Raven Door Sealing Systems are available to combat draughts, dust, rain, noise, heat loss, heat gain, fire, smoke and stray light.
- With solutions for a wide range of door opening types including butt hinged, up and over, sliding, roller shutter and revolving.
- The following is a selection of the Raven Smoke
- Rated Seals available from the comprehensive range shown on www.astrodraft.com.

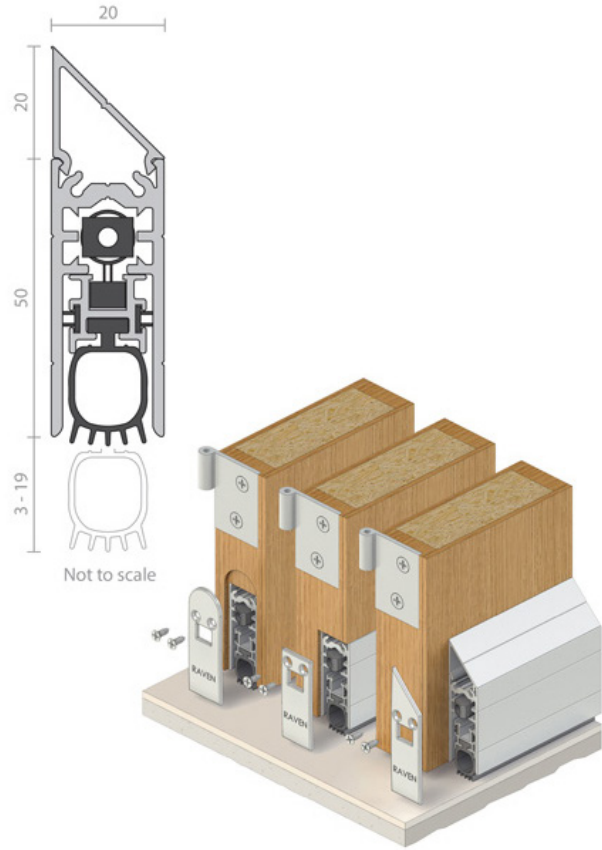

Product Description

Raven Seals have been designed to accommodate a variety of duty levels, classified on this web site as light, medium and heavy.

L Light Duty seals include those typically used in residential applications or light traffic areas.

M Medium Duty seals are used in commercial applications such as office spaces, shops, commercial accommodation or medium trafficked areas.

H Heavy Duty seals are designed for areas with a high level of use such as public places such as hospitals, airports, factories, shopping centres or areas with a large flow through of pedestrian and wheeled traffic.

Product Availability

H RP8Si

A hot smoke automatic door bottom seal, with an extruded silicon sealing component, that conforms to the 200 degrees Celsius requirement of BCA c3.4.

RP8Si is spring loaded to lift clear of the floor as soon as the door leaf is opened by a few millimetres.

Mounted into a 15mm x 34mm groove that has been mortised into the bottom edge of the door, it is operated automatically by pressure against the door jamb on its adjusting screw.

RP8Si has been tested for durability 1,000,000 cycles completed without failure. Min/Max Gap 3mm/13mm.

Location

Single and double, butt hinged doors.

Fixing Method

Concealed, with supporting colour matched stainless steel escutcheon plates.

Screws supplied

Seal Material

Silicon rubber (SE) (Charcoal)

Replacement Seal RP308si.

Optional

Stainless steel rounded escutcheon plate RP8cp2(clear)
RP8bp2(bronze).

Escutcheon plate dimensions

Rounded: 22mm wide, 57mm high, (22mm dia router bit) 1.2mm thick

Rectangular: 22mm wide, 60mm high, 1.2mm thick

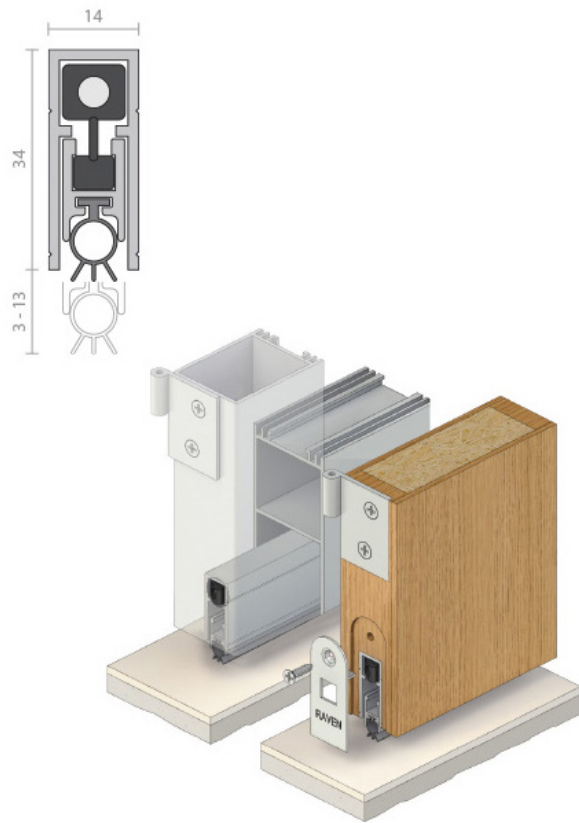

Product Code	Product Description	Size	Lengths	Colour
ADRP8SI/380	Raven RP8Si	14 x 34 x 13mm	380mm	Anodised Satin Clear
ADRP8SI/600	Raven RP8Si	14 x 34 x 13mm	600mm	Anodised Satin Clear
ADRP8SI/820	Raven RP8Si	14 x 34 x 13mm	820mm	Anodised Satin Clear
ADRP8SI/915	Raven RP8Si	14 x 34 x 13mm	915mm	Anodised Satin Clear
ADRP8SI/1070	Raven RP8Si	14 x 34 x 13mm	1070mm	Anodised Satin Clear
ADRP8SI/1220	Raven RP8Si	14 x 34 x 13mm	1220mm	Anodised Satin Clear

- Other colours are available on request

Product Availability

H RP38Si

A medium temperature smoke door bottom seal, with an extruded silicon sealing component, that conforms to the 200 degrees Celsius requirement of BCA spec c3.4. It is a heavy duty automatic door bottom seal which is spring loaded to lift clear of the floor as soon as the door leaf is opened by a few millimetres.

The seal is operated automatically by pressure against the door jamb on the adjusting screw. It seals when the door closes and retracts automatically when the door is opened. It is self leveling. Min/Max Gap up to 13mm.

Location

Single or double, butt hinged doors., minimum thickness 45mm.

RP38Si has been fire tested to AS1530.4 AS/ NZS1905.1. It can be face mounted or semi mortised in proprietary poa.

Fixing Method

Fully mortised, can be adjusted, escutcheon plates provided.

Seal Material

Silicon rubber (SE) (charcoal colour)

Replacement Seal RP338si.

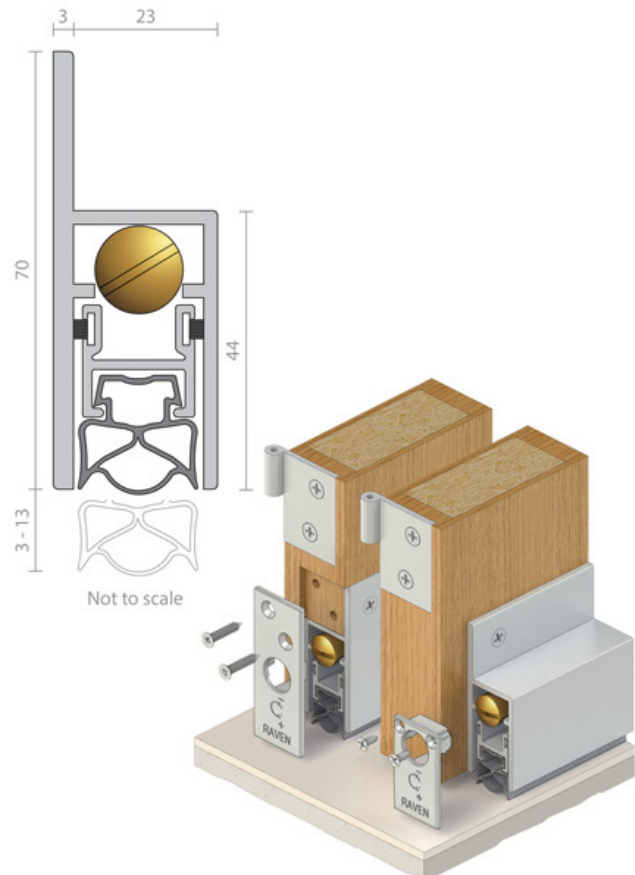

Product Code	Product Description	Size	Lengths	Colour
ADRP38Si/450	Raven RP38Si	3-13 x 70 x 3 x 23 x 44mm	450mm	Anodised Satin Clear
ADRP38Si/610	Raven RP38Si	3-13 x 70 x 3 x 23 x 44mm	610mm	Anodised Satin Clear
ADRP38Si/915	Raven RP38Si	3-13 x 70 x 3 x 23 x 44mm	915mm	Anodised Satin Clear
ADRP38Si/1067	Raven RP38Si	3-13 x 70 x 3 x 23 x 44mm	1067mm	Anodised Satin Clear
ADRP38Si/1220	Raven RP38Si	3-13 x 70 x 3 x 23 x 44mm	1220mm	Anodised Satin Clear
ADRP38Si/1500	Raven RP38Si	3-13 x 70 x 3 x 23 x 44mm	1500mm	Anodised Satin Clear

- Other colours are available on request

Product Availability

H RP70Si

The RP70Si automatic seal is the fully mortised version of the RP38Si door seal. It is a heavy duty door bottom seal which is spring loaded to lift clear of the floor as soon as the door leaf is opened by a few millimetres.

The seal is operated automatically by pressure against the door jamb on the adjusting screw. It seals when the door closes and retracts automatically when door is opened. It is self leveling.

When using RP70Si door bottom seal, the door must be a minimum of 45mm thick and of suitable construction for mortising this seal. It is reversible for left or right handed operation.

Note: For double doors, plain meeting stiles are required.

RP70Si has been tested for durability ~ 1,000,000 cycles completed without failure. Min/Max Gap up to 13mm.

Location

Single or double, butt hinged doors., minimum thickness 45mm.

Fixing Method

Fully mortised, can be adjusted, escutcheon plates provided.

Seal Material

Silicon rubber (SE) (charcoal colour)

Replacement Seal RP338Si.

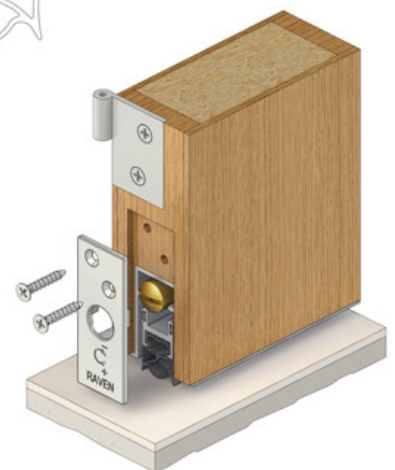
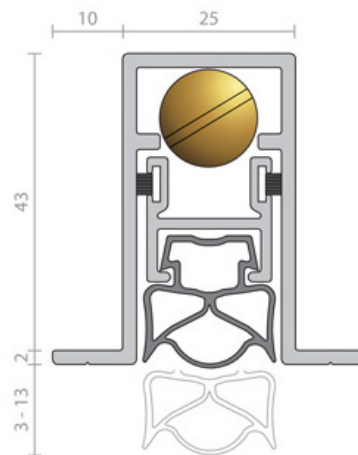

Product Code	Product Description	Size	Lengths	Colour
ADRP70SI/450	Raven RP70Si	3-13 x 43 x 10 x 25mm	450mm	Anodised Satin Clear
ADRP70SI/610	Raven RP70Si	3-13 x 43 x 10 x 25mm	610mm	Anodised Satin Clear
ADRP70SI/915	Raven RP70Si	3-13 x 43 x 10 x 25mm	915mm	Anodised Satin Clear
ADRP70SI/1067	Raven RP70Si	3-13 x 43 x 10 x 25mm	1067mm	Anodised Satin Clear
ADRP70SI/1220	Raven RP70Si	3-13 x 43 x 10 x 25mm	1220mm	Anodised Satin Clear
ADRP70SI/1500	Raven RP70Si	3-13 x 43 x 10 x 25mm	1500mm	Anodised Satin Clear

- Other colours are available on request

Product Availability

H RP99Si

Raven RP99Si is a heavy duty automatic door bottom seal which is spring loaded to lift clear of the floor as soon as the door leaf is opened by a few millimetres. An acoustically designed seal for face mounted , semi mortised or fully mortised applications. It is operated automatically by pressure against the door jamb on its adjustment block. RP99Si seals when the door closes and retracts automatically when the door is opened

RP99Si has been tested for durability, 1,000,000 cycles completed without failure.

RP99Si conforms to the 200 degrees Celsius requirement of BCA c3.4 spec, for fire rated & medium smoke doors. All fitting options have been tested and approved on proprietary fire doors to 120 minutes AS1530.4 and AS/NZS2905.1. Min/Max Gap 1mm/19mm.

Location

Solid core single and double broad butt hinged doors. Face fix, fully and semi mortised applications. Minimum door thickness 40mm recommended.

Fixing Method

Zinc plated, cross recess head S.T. screws of the appropriate size are supplied. Colour matched escutcheon plates included.

Seal Material

Silicon rubber (SE) (charcoal colour)

Replacement Seal RP347si.

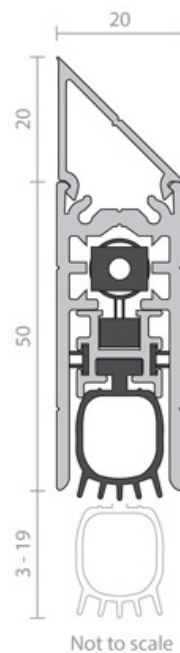

Product Code	Product Description	Size	Lengths	Colour
ADRP99Si/380	Raven RP99Si	3-19 x 50 x 20 x 20mm	380mm	Anodised Satin Clear
ADRP99Si/600	Raven RP99Si	3-19 x 50 x 20 x 20mm	600mm	Anodised Satin Clear
ADRP99Si/720	Raven RP99Si	3-19 x 50 x 20 x 20mm	720mm	Anodised Satin Clear
ADRP99Si/820	Raven RP99Si	3-19 x 50 x 20 x 20mm	820mm	Anodised Satin Clear
ADRP99Si/915	Raven RP99Si	3-19 x 50 x 20 x 20mm	915mm	Anodised Satin Clear
ADRP99Si/1070	Raven RP99Si	3-19 x 50 x 20 x 20mm	1070mm	Anodised Satin Clear
ADRP99Si/1200	Raven RP99Si	3-19 x 50 x 20 x 20mm	1200mm	Anodised Satin Clear

- Other colours are available on request

Product Availability

H RP129Si

A silicon rubber seal in a 15 micron anodised Aluminium carrier.

Seal carrier is pre-drilled with fixing slots at regular intervals and matching screws are supplied.

The seal can be checked out or drilled to accommodate the pivot, thereby providing a continuous seal.

Durability Tested to over 1,000,000 operating cycles without failure.

Full installation instructions are included with the product. Min/Max Gap 14mm to 18mm.

Location

Double butt hinged and centre pivot double acting doors.

Fixing Method

Zinc plated, cross recess S.T. screws of the appropriate size and colour are supplied.

Seal Material

Silicon Rubber (SE) (Light grey)

Used in Conjunction

Raven threshold plates. Raven RP115 Threshold Plate recommended.

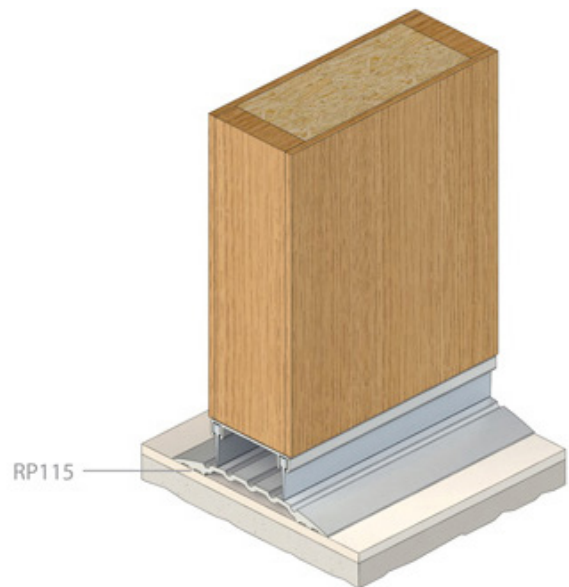
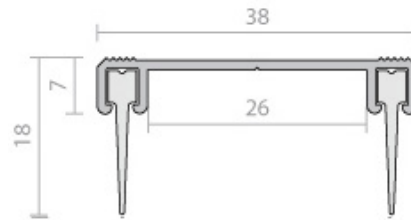

Product Code	Product Description	Size	Lengths	Colour
ADRP129Si/1250	Raven RP129Si	18 x 38mm	1250mm	Anodised Satin Clear

To Order & Specify

Please contact us and quote the following information -
Quantity / Product Code / Product Description / Size / Length
Typical example:- 5 / ADRP129SI/1250 / Raven RP129Si / 18 x 38mm / 1250mm

>> Tel: [01329 844 500](tel:01329844500) or >> Email: sales@astroflame.com

Installation

Please see installation sheet - This can be requested from our sales team T: [01329 844 500](tel:01329844500)
or E: sales@astroflame.com

Health and Safety

Please see (SDS) Safety Data sheet - This can be requested from our sales team T: [01329 844 500](tel:01329844500)
or E: sales@astroflame.com

As part of our policy of ongoing improvements, we reserve the right to modify, alter or change product specifications without giving notice. Product illustrations are representations only. All information contained in this document is provided for guidance only, and as ASTROFLAME FIRESEALS LTD has no control over the installation methods of the products, or of the prevailing site conditions, no warranties expressed or implied are intended to be given as to the actual performance of the products mentioned or referred to, and no liability whatsoever will be accepted for any loss, damage or injury arising from the use of the information given of products mentioned or referred to herein.

The above information to the best of our knowledge is true and accurate and based upon current test data and is supplied for your guidance only. Customers should satisfy themselves to the suitability of the product in its intended use and no guarantee is given or implied since the conditions of actual use are beyond our control. ASTROflame (Fireseals) Ltd, disclaim any liability for loss, damage or other expense arising from the use of information, data or products mentioned or referred to and reserve the right to change any details or specifications without notice.